



# "Turn-Key" Model Home In McDonald, PA Wagner Development

Easy Access To Downtown Pittsburgh!

## 28x60

Approximate 1,639 Square Feet

**G1923** – Approximately 28x60, 3 bedrooms with 2 baths model. Fully residential exterior with thermopane windows and 25 year shingles, exterior sheathing, 2x6 walls on 16" centers, 7 1/2' side walls, drywall ceiling, fiberglass front and rear doors, appliance package with microwave and dishwasher, R19-27-38 Energy Star insulation package, upgrade cabinets, ceiling fan, plush carpet with heavy padding and more.



## 28x52

Approximate 1,420 Square Feet

**G1791 Reverse** – Approximately 28x52, 3 bedrooms with 2 baths model. Fully residential exterior with thermopane windows and 25 year shingles, 4x14 porch, exterior sheathing, 2x6 walls on 16" centers, 7 1/2' side walls, drywall ceiling, fiberglass front and rear doors, appliance package with dishwasher, R19-27-38 Energy Star insulation package, upgrade cabinets, plush carpet with heavy padding and much more.

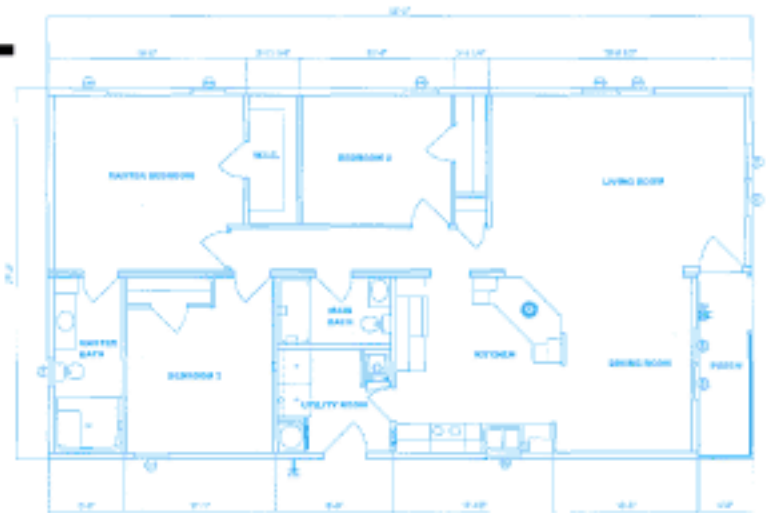

### Price Includes:

Piers  
Air Conditioning  
Skirting  
Tie Downs

Utilities Hooked up  
Steps w/ Landings  
Blocks

# Riverview Homes, Inc.

Vandergrift	Butler	Clarion Co.	Apollo	Greene Co.	Greensburg	Prospect	New Alexandria
ROUTE 66 - between Vandergrift & Leechburg	ROUTE 6 - five miles North of Butler	ROUTE 66 - 1/2 miles North of Route 322	ROUTE 56 - one mile East of Apollo	ROUTE 21 - between Uniontown & Waynesburg	ROUTE 115 - between Greensburg & Youngwood	ROUTE 422 - midway between Rte 79 & Butler	ROUTE 22 - between Blairsville & New Alex
(724) 567-5647	(724) 282-4666	(814) 223-9252	(724) 478-1991	(724) 966-5056	(724) 834-3960	(724) 865-9930	(724) 668-2297

## From Vandergrift:

Take PA-56 West to New Kensington. Turn onto PA-366 West and cross Allegheny River into Tarentum. Take PA-28 South to Pittsburgh. Take I-579 South and then take I-279 South for 1½ miles. Merge onto I-376 West and go 10 miles to Exit 60A onto US-22/30 West towards Weirton, WV. In about 1½ miles, take the Oakdale Exit and turn Left onto McKee Road. Go for 2 miles to PA-978 (Oakdale Road) and turn Right onto Noblestown Road (take the 2nd left to stay on Noblestown Road). Go 1½ miles and turn Right onto Finks Run Road and then take the 1st Left onto Jess Lane. Immediately turn Left to stay on Jess Lane. The model homes are located at 25 and 26 Jess Lane.

## From Greensburg:

Take PA-66 North to Delmont and then take US-22 West (Wm Penn Hwy) to I-376 West for about 25 miles. Take US-22/30 West towards Weirton, WV. In about 1½ miles, take Oakdale Exit and turn Left onto McKee Road. Go for 2 miles to PA-978 (Oakdale Road) for 1 mile and turn Right onto Noblestown Road (take the 2nd left to stay on Noblestown Road). Go 1½ miles and turn Right onto Finks Run Road and then take the 1st Left onto Jess Lane. Immediately turn Left to stay on Jess Lane. The model homes are located at 25 and 26 Jess Lane.

## From Carmichaels:

Take PA-88 North to PA-188 West (Jefferson Road). Go 5 miles and turn right onto PA-221 North (Lippencott Road). Take I-79 North for about 25 miles through the I-70 interchange area. Take exit 45 towards PA-980 and turn Left onto Weavertown Road and then take the 2nd Left onto Morganza Road. Morganza Road turns slightly right and becomes Euclid Ave. Turn Left onto PA-980 North for about 8 miles. Turn Right onto East Lincoln Ave to Noblestown Road. Turn Left onto Finks Run Road and then take the 1st Left onto Jess Lane. Immediately turn Left to stay on Jess Lane. The model homes are located at 25 and 26 Jess Lane

*Riverview Homes, Inc.*

Vandergrift	Butler	Clarion Co.	Apollo	Greene Co.	Greensburg	Prospect	New Alexandria
ROUTE 66 - between Vandergrift & Brockway	ROUTE 8 - 1/2 miles North of Butler	ROUTE 96 - 1 1/2 miles North of Route 322	ROUTE 36 - 1/2 mile East of Apollo	ROUTE 21 - between Uniontown & Waynesburg	ROUTE 115 - between Greensburg & Youngwood	ROUTE 422 - midway between Rte 79 & Butler	ROUTE 22 - between Blairsville & New Alex
(724) 567-5647	(724) 282-4666	(814) 223-9252	(724) 478-1991	(724) 966-5056	(724) 834-3960	(724) 865-9930	(724) 688-2297